

DSL WIRING DIAGRAM

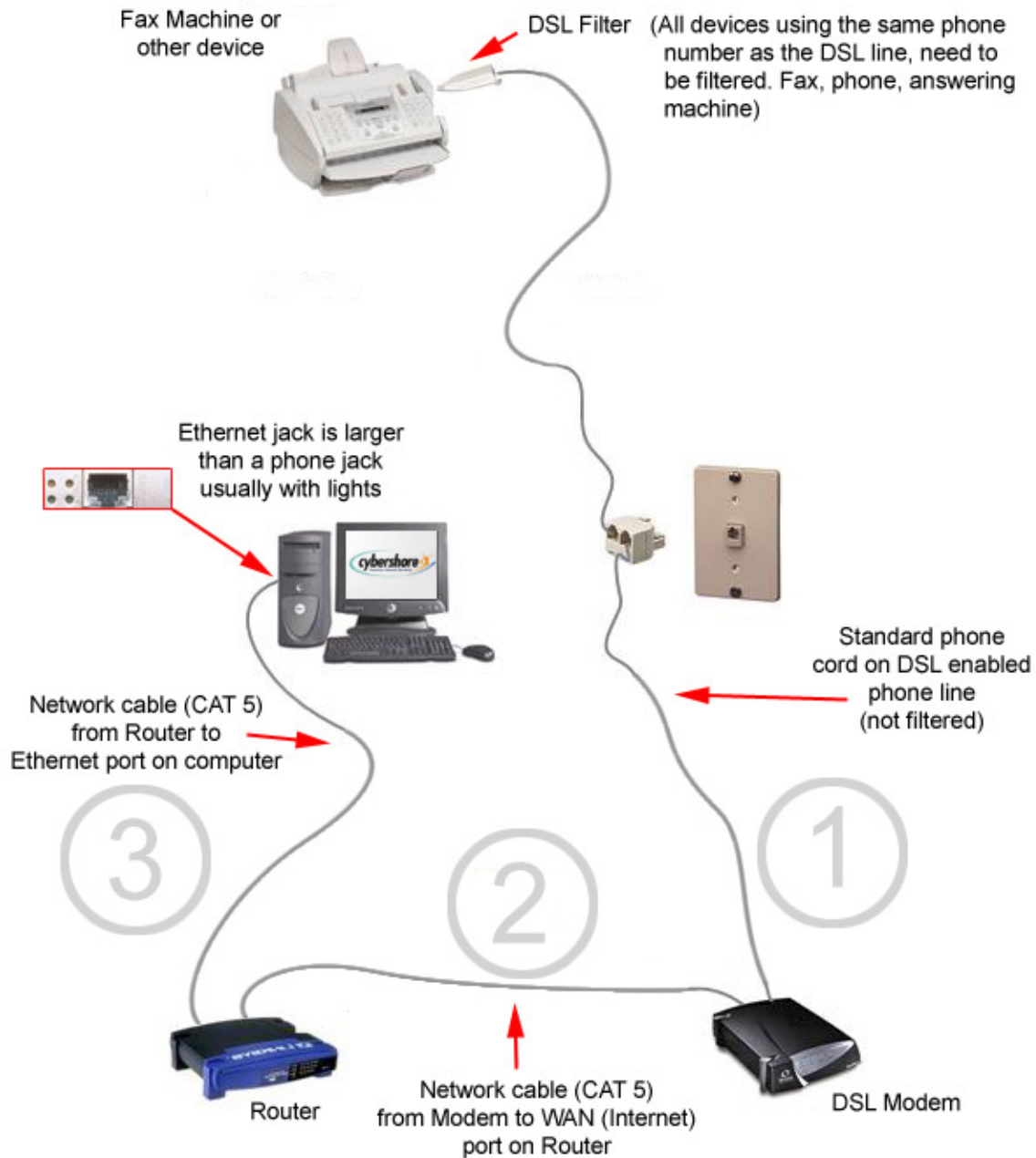

1. Wall Jack to splitter (optional), unfiltered line to DSL Modem.
 2. Network cable from Modem to the Router's WAN Port.
 3. Network cable from 10/100 port to Ethernet port on computer.
- *Network cable is thicker than phone cord and has bigger clip.

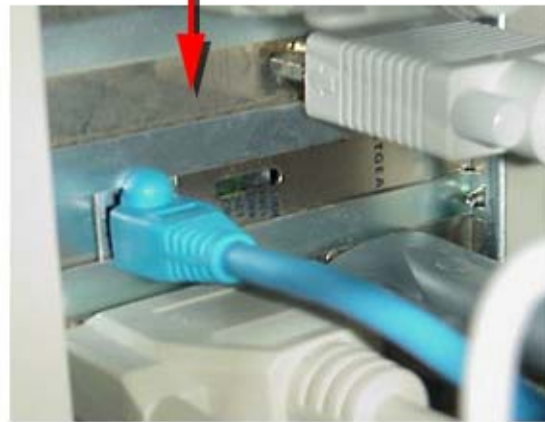
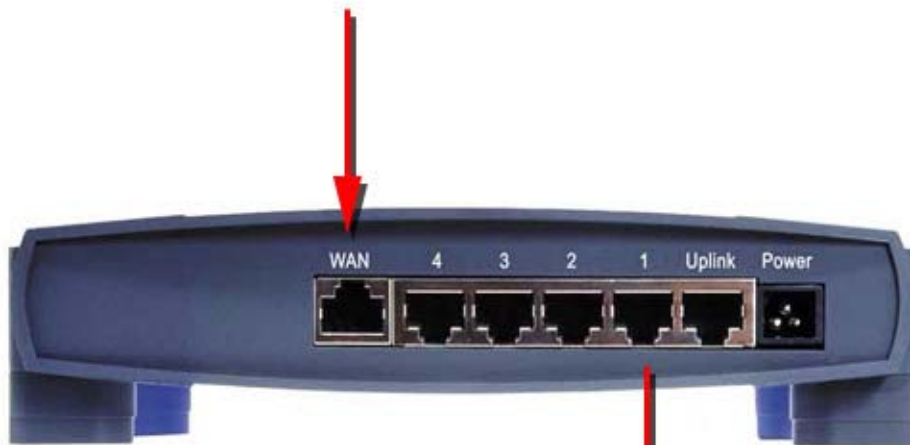

1. Phone line (unfiltered) to the DSL modem
2. Network cable from modem to WAN port or Internet Port on router
3. Do not use the uplink port.
4. From one of the ports labeled 1-4 connect a network cable to the computer's Ethernet port.

When your wiring is complete and the power is on on all equipment. Open up your Internet browser and go to <http://192.168.1.1> A page similar to the one below will appear. Router name and Domain are not needed. Dot the radio button that reads “Obtain IP address automatically”. Then go to PPPoE and enter your username and password. The username must be followed by @cshore.com (no spaces). Hit apply or “Save Settings”

LINKSYS

Setup Password Status DHCP Help Advanced

SETUP

This screen contains all of the router's basic setup functions. Most users will be able to use the router's default settings without making any changes. If you require help during configuration, please see the user guide.

Router Name: (Required by some ISPs)

Domain Name: (Required by some ISPs)

Firmware Version: 1.21.1, Mar 24 2000

LAN IP Address: (MAC Address: 00-20-78-C6-84-52)
192 . 168 . 1 . 1 (Device IP Address)
255.255.255.0 (Subnet Mask)

WAN IP Address: (MAC Address: 00-20-78-C6-84-53)
 Obtain an IP Address Automatically
 Specify an IP Address . . .
Subnet Mask: . . .
Default Gateway Address: . . .
DNS (Required)
1: . . .
2: . . .
3: . . .

PPPoE: **Enable** **Disable**
User Name:
Password:

Apply Cancel Help